



Road Running Technical Council
USA Track & Field

Measurement Certificate



Name of the course _____ Distance _____

Location (state) _____ (city) _____

Type of course: road race calibration track Configuration: _____

Type of surface: paved _____ % dirt _____ % gravel _____ % grass _____ % track _____ %

Elevation above sea level) Start _____ Finish _____ Highest _____ Lowest _____

Straight line distance between start & finish _____ Drop _____ m/km Separation _____ %

Measured by (name, address, phone & e-mail) _____

Race contact (name, address, phone & e-mail) _____

Measuring Methods: bicycle steel tape electronic distance meter

Number of measurements of entire course: _____ Date(s) when course measured: _____

Race date: _____ Course certification effective date: _____

Certification code: _____

Notice to Race Director: Use this Certification Code in all public announcements relating to your race.

Be It Officially Noted That

Based on examination of data provided by the above named measurer, the course described above and in the map attached is hereby certified as reasonably accurate in measurement according to the standards adopted by the Road Running Technical Council. If any changes are made to the course, this certification becomes void, and the course must then be recertified.

Verification of Course — In the event a National Open Record is set on this course, or at the discretion of USA Track & Field, a verification remeasurement may be required to be performed by a member of the Road Running Technical Council. If such a remeasurement shows the course to be short, then all pending records will be rejected and the course certification will be cancelled.

This certification expires on December 31 in the year

AS NATIONALLY CERTIFIED BY:

[Signature]

Date: _____

[Signature]

Date: _____



Mission 10 Miler Frederick, MD

Measured by Tim O'Keefe 3/8/2014

START/FINISH – Stadium Dr in line with center of entrance doors to stadium & center of grave marker John W Bagent. 6'4" SW of No Parking sign. 56'5" SW of large utility pole

1/9 – On New Design Road near Crestwood Rd. In line with N corner of Parkway Community Church

2/8 – On New Design Rd. 30'10" S of S edge of house 5203

3/7 – On New Design Rd. by English Muffin Way. In line with flagpole in front of bldg. 6701

4/6 – Elmer Derr Rd near Ballenger Creek Rd. 21'11" S of Allegheny Power Pole 1246927

5/turnaround – In front of Tuscarora H S on Ballenger Cr. Rd even with fire hydrant 05163 at traffic light

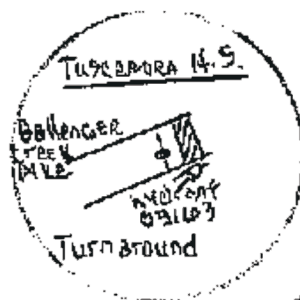
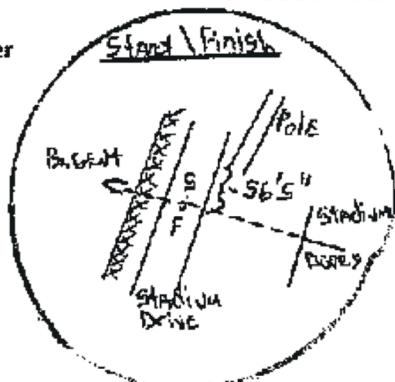

Certified Course
#MD14008LMJ
Effective 3-28-2014
Through 12-31-2024

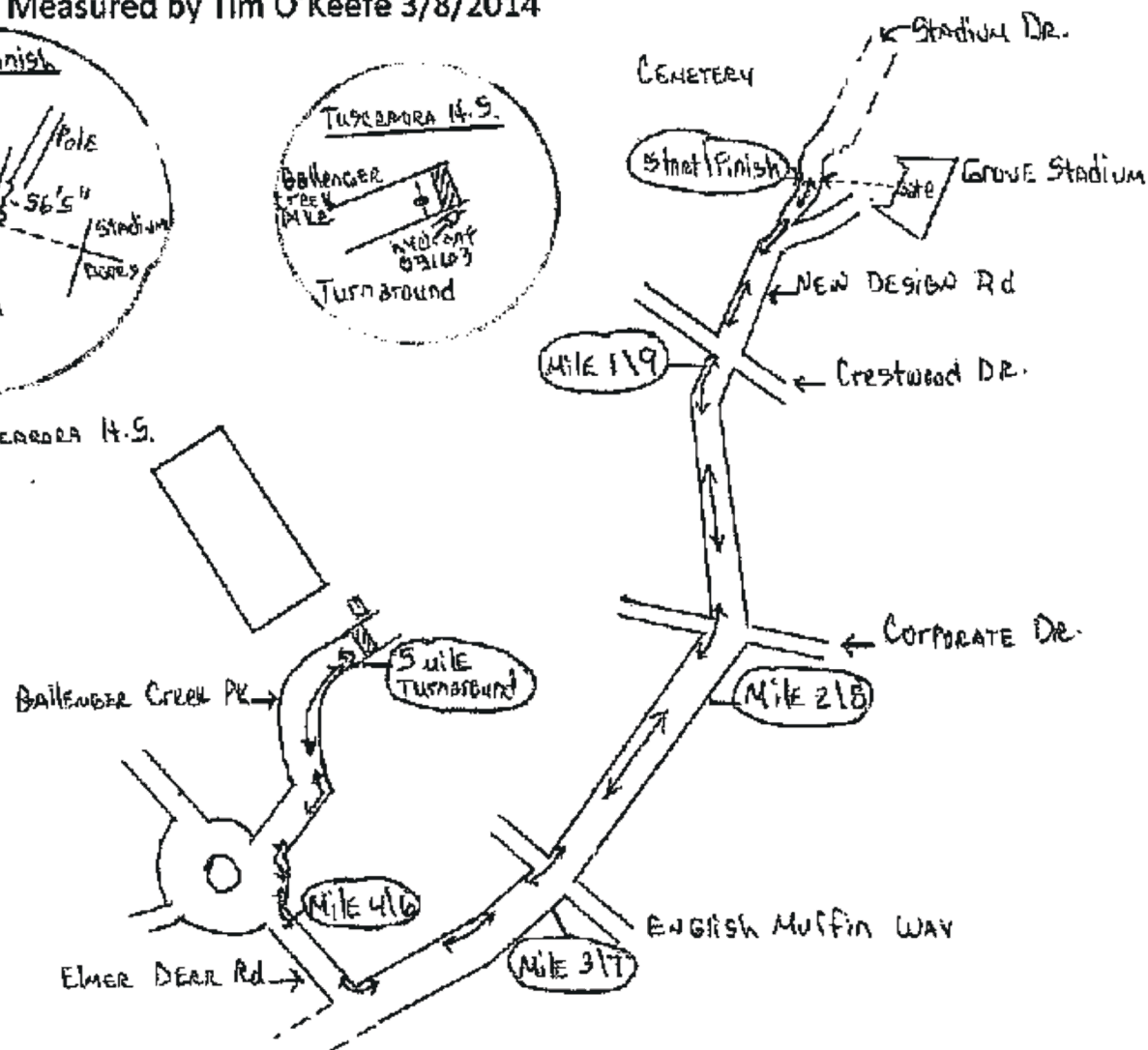

RUNNERS MUST STAY ON ONE SIDE OF THE ROAD – WITH TRAFFIC GOING OUT/AGAINST TRAFFIC COMING BACK

START/FINISH AND ALL MILES MARKED ON ROAD WITH A NAIL IN A WASHER IN THE ROAD SURFACE